

Garden Project Notes and Wish List

New Beginnings Child Development Center already has quite a bit of natural material in the garden area. We have a large volume of River Rock, volcanic rock, two large rocks, and a few trees that should be incorporated in the design. Additional materials will be purchased.

Although a Zen and Children's Gardens can range from simple to complex, please keep in mind that both areas will need to be maintained year-round by the Center's staff and children, so we are asking that ease of maintenance for areas and plants be taken into consideration when creating a design.

Attached is a list of acceptable plants that can be used for both gardens. There is also a list of toxic plants that we are not allowed to have at the Center.

Additionally, please keep in mind the potential for attracting our desert critters as well as bees and wasps when looking at plants.

Our Wish list:

- A small pergola with a bench underneath
- Concrete benches and a small concrete table
- A child-safe water fountain (run during months that wasps are not abundant)
- Rock or concrete paths (keeping in mind handicapped access)
- Plants/flowers that children can easily water and maintain.

We have included diagrams with dimensions and photos of the two areas. However, nothing beats seeing them in person and walking around them to get a better feel of the space. If you would like to stop by, please contact the Center's front desk at 520-533-5209 and let us know you are coming. The Center is open from 0530 to 1730 hours, Monday through Friday.

NBCDC - Garden Project Right Side - Zen Garden

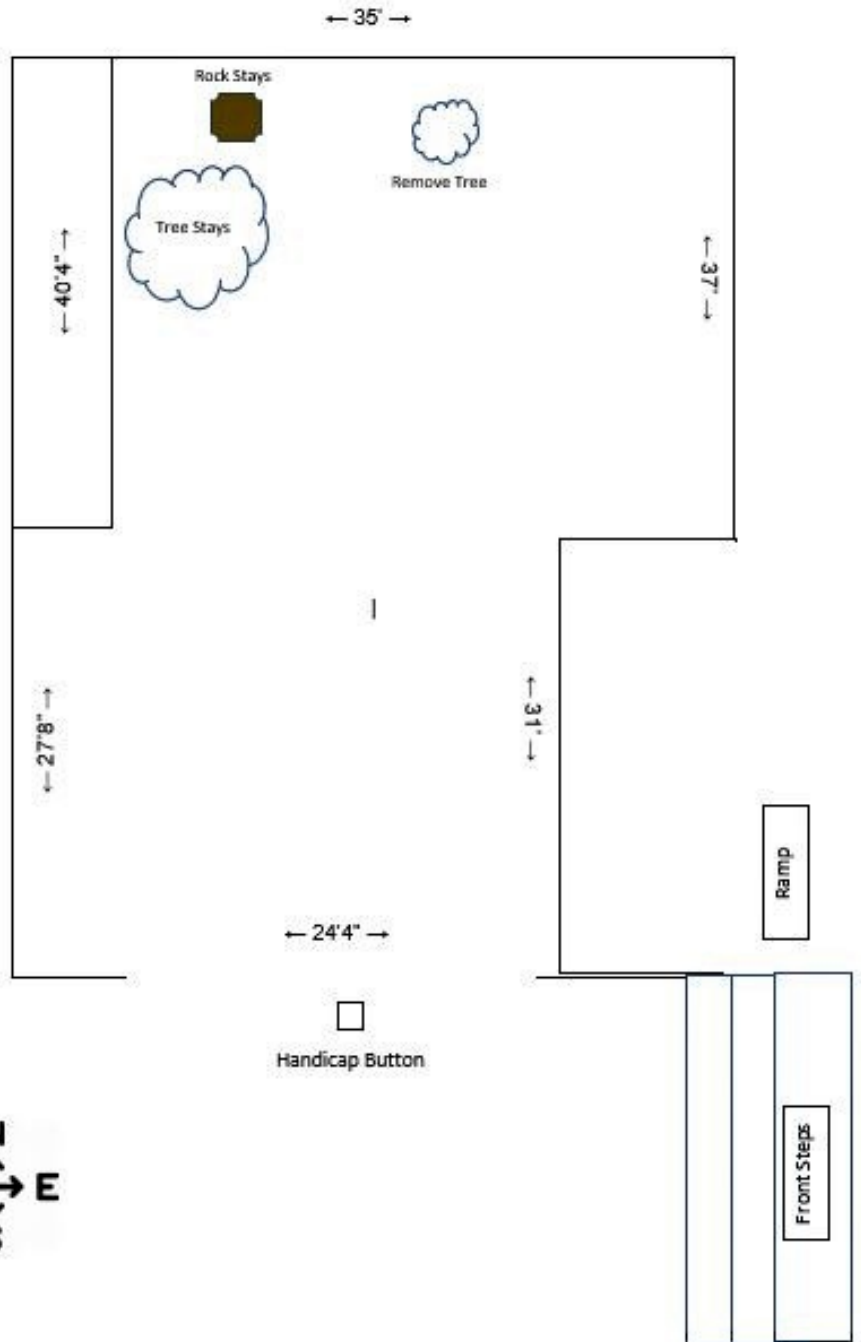

NBCDC - Garden Project Left Side - Children's Garden

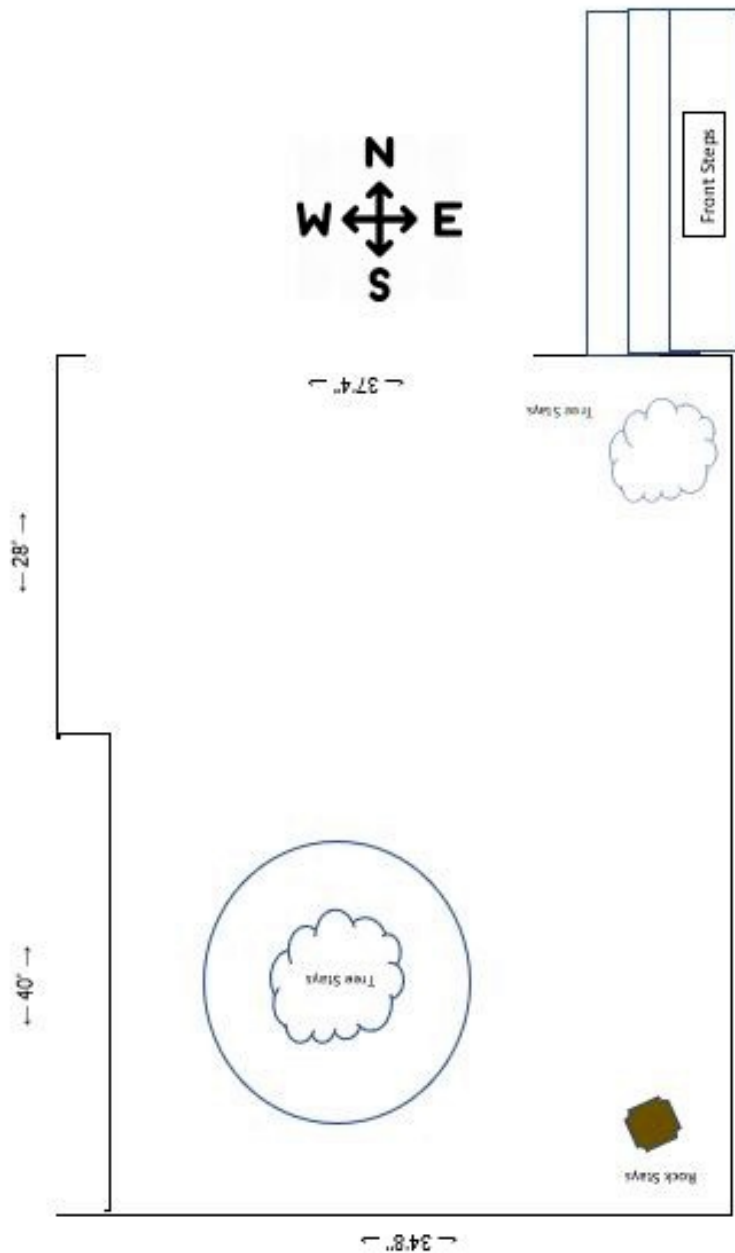

Non-Toxic Plant List

Abella	Coleus	Norfolk Pine
Abyssinian SwordLily	Copperleaf Plant	Palm
African Daisy	Corn Plant	Panda Plant
African Palm	Creeping Jennie	Pepperomia
African Violet	Dahlia	Petunia
Air Fern	Daisies	Phylox
Airplane Plant	Dandelion	Pitcher Plant
Aluminum Plant	Dogwood	Prayer Plant
Aralia	Donkey Tail	Pregnant Plant
Araucaria	Dracaena Easter	Rose
Areca Palm	Lily Echeveria	Rose of Sharon
Asparagus Fern	Eugenia	Rubber Tree
Aspidistra	Fig	Sanseveria
Aster	Grapelvy	Schefflera
Baby's Breath	Hens & Chicks	Sensitivity Plant
Baby's Tears	Hibiscus	Snap Dragon
BachelorButtons	Honeysuckle	Spider Plant
Bamboo	Hoya Impatiens	Swedish Ivy
BananaPlant	Jade Plant	Tiger Lily
Begonia	Kalanchoe	Tuplip Tree
Bird's Nest Fem	Lily	Umbrella
Blood Leaf	Lipstick Plant	Violets
Boston Fern	Magnolia	Wandering Jew
Bougainvillea	Marigold	Weeping Fig
Bridal Veil Plant	Monkey Plant	Weeping Willow
Burro Tail	Mother-in-Law	Wild Onion
California Holly	Tongue	Yucca
California Poppy	Mountain Ash	Zebra Plant
Camellia		Zinnia
Chinese Evergreen		
Christmas Cactus		

Common Poisonous Plants
(excluded by Army Regulation 608-10)

Aloe Vera	Hemlock	Philodendron
Anemone	Holly	Poinsettia
Angel Trumpet Tree	Horsetail Reed	Poison Hemlock
Angel Wings	Hyacinth	Poison Ivy & Poison Oak
Apricot Kernels	Hydrangea	Pokeweed, Pokeberry
Arrowhead vines	Iris	Primrose
Autumn Crocus	Ivy (Boston, English, others)	Ranunculus
Avocado Leaves	Jack-In-The-Pulpit	Rhododendron
Azalea	Jasmine	Rhubarb
Betel Nut Palm	Jerusalem Cherry	Rosary Pea
Bittersweet	Jessamine Pea	Start of Bethlehem
Black Locust	Jimson Weed	Sweet pea
Bleeding Heart	Jonquil	Tobacco
Buckeye (Bottlebrush, California)	Lantana	Tulip
Buttercup	Larkspur	Water hemlock
Caladium	Laurel (English laurel, laurel-cherry)	Wisteria
Calla Lily	Lily-of-the-Valley	Yew
Castor Bean	Lobelia	Additionally, any plants with spines, thorns, or stickers (e.g., cactus, rosebush, etc.) are not permitted.
Cattail	Marijuana	
Cherry, Wild and Cultivated	Mayapple (Mandrake)	
Christmas Rose	Milkweed	
Chrysanthemum	Mistletoe	
Crocus (Autumn)	Moonseed	
Croton	Monkshood	
Daffodil	Morning Glory	
Daphne	Mother-In-Law Plant	
Deadly Nightshade	Mountain Laurel	
Delphinium	Mushroom	
Devil's Ivy	Narcissus	
Dumb Cane	Nightshade, Horse Nettle	
Dutchman's Breeches	Oleander	
Elderberry	Orchid (Ladyslipper)	
Elephant Ear	Ornamental Pepper	
Four O'Clock	Peace Lily	
Foxglove	Pencil Tree; Milk Bush	
Golden Chain	Periwinkle	
	Peyote	